

198 FRESHWATER BLVD., ENFIELD, CT 06082  
 TEL: 860-745-7475 FAX: 860-745-7477

The **MSC Filtration Technologies PSK Pump** is a powerful, all purpose positive displacement, progressive cavity pump. It is designed to deliver superior performance, pumping a broad range of fluid applications. The **PSK Pump** offers longer life in abrasive and non-lubricating applications.

## Typical Applications

### Machine Tool

- ◆ Cutting/Grinding Oils
- ◆ Slurries
- ◆ Metering
- ◆ Chemical De-burring
- ◆ Polishing Oils
- ◆ Dielectrics
- ◆ Cooling Oils
- ◆ Abrasives

### Water and Waste Water

- ◆ Polymer Transfer
- ◆ Booster
- ◆ Sampling

### Industrial

- ◆ Machine Coolants
- ◆ Oil/Fluid Recovery
- ◆ Oil/Water Separators
- ◆ Abrasives
- ◆ Inks/Dyes

### Agricultural Applications

- ◆ Food/Beverage
- ◆ Plant Feed

### Petrochemical

- ◆ Waste Oil Recovery
- ◆ Abrasive Chemicals
- ◆ Chemical Transfer

### Medical/Biotech

- ◆ Control Equipment

## Features

- ◆ Self Priming
- ◆ Pressure to 150 psi
- ◆ Flow rates 2 - 50 gpm
- ◆ OEM Applications
- ◆ Easy Maintenance/Repair
- ◆ Temperatures to 250 F
- ◆ Single or Three Phase
- ◆ 1/2HP Motor Standard
- ◆ Inter-Changeable Parts

## PSK PROGRESSIVE CAVITY PUMP SERIES

Positive displacement industrial pumps  
 Available 2 gpm - 50 gpm

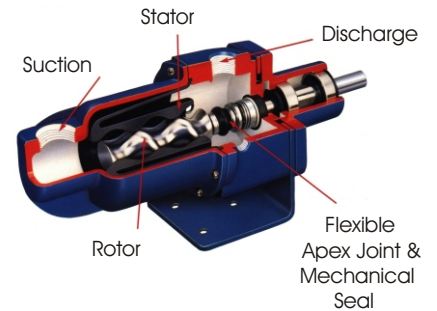
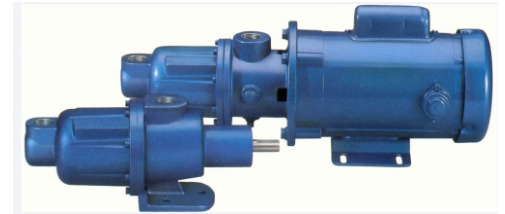

## The PSK Progressive Cavity Design

The progressive cavity design forms a series of sealed cavities, these cavities contain the pumped fluid. As the rotor turns, the cavities "progress" from the suction to the discharge end of the pump, moving the fluid. The result is a constant, uniform, non-pulsating flow, that provides low shearing action for minimum degradation of pumped materials and low velocity capabilities for effectively pumping viscous fluids.

Careful quality control ensures the optimal compression fit between the rotor and stator to provide superior pump performance and long life. In abrasive applications, the stator's ability to deform slightly to accommodate solid particles contributes to its abrasive resistance characteristics.

\* The simple PSK design provides the user with the option of alternating pumping from 2 gpm to 15 gpm with a simple change of the rotor and stator.

### Simple Inter-Changeable Parts

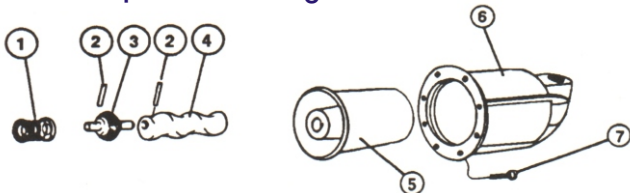

**To Order Correct Replacement Parts**  
**Use Pump Model Number**

- |                            |                   |
|----------------------------|-------------------|
| 1 Mechanical Seal & Spring | 5 Stator          |
| 2 Pin                      | 6 Suction Housing |
| 3 Flexible Apex Joint      | 7 Housing Screws  |
| 4 Chrome Plated Rotor      |                   |



PSK Stator & Rotor

### Emergency! Portable Pump



Model 50-16

Emergency Portable Pump Series

# Pump Specifications Data

Cost effective progressive cavity pumps design

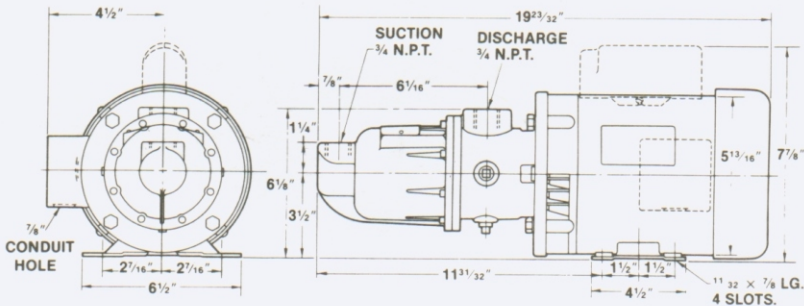

**PKR - P-2;4; 6; 9; or 15**

Materials of Construction	
Component	Material
Housing	Cast Iron
Rotor	416 SS/CP
Stator	NBR (Nitrile)

SS = Stainless Steel  
CP = Chrome Plated

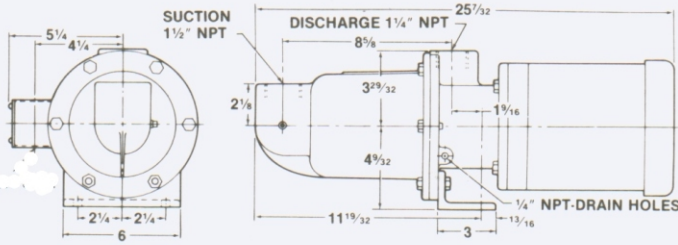

**PKR - P - 25**

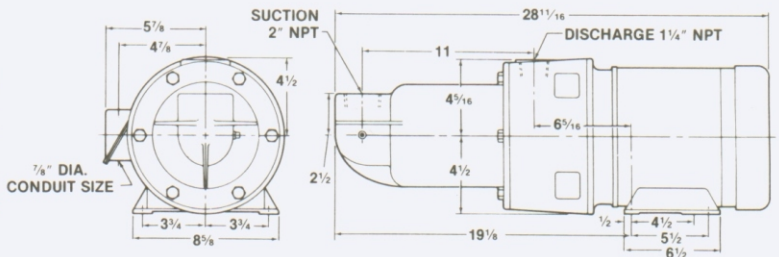

**PKR - P - 50**

### Ratings (Pressure, GPM, HP)

MODEL NUMBER	PSI PRESSURE	PERFORMANCE G.P.M.- R.P.M. OF WATER AT 70°F.						H.P.	PHASE
		1750	1425	1140	950	700			
PKR-P-2	0	2.10	1.55	1.25	1.0	.75	1/2	3	
	25	1.70	1.40	1.15	.80	.60	1/2	3	
	50	1.40	1.22	.95	.70	.50	1/2	3	
PKR-T-2	75	1.25	1.05	.80	.55	.40	1/2	1	
	100	1.0	.90	.72	.44	.32	1/2	1	
	125	.75	.65	.50	.30	.25	1/2	1	
PB2	150	.60	.45	.30	.24	.19	PUMP ONLY		
PKR-P-4	0	4.70	3.90	3.20	2.65	1.45	1/2	3	
	25	4.05	3.30	2.70	2.25	1.40	1/2	3	
	50	3.40	2.70	2.25	1.85	1.33	1/2	1	
PKR-T-4	75	2.80	2.25	1.75	1.45	1.20	1/2	1	
	100	2.30	1.75	1.45	1.20	.95	PUMP ONLY		
	150	2.30	1.75	1.45	1.20	.95	PUMP ONLY		
PKR-P-6	0	6.20	5.15	4.40	3.50	2.50	1/2	3	
	25	5.45	4.50	3.70	3.00	1.88	1/2	3	
	50	4.70	3.70	3.00	2.55	1.20	1/2	1	
PKR-T-6	75	3.90	3.10	2.40	2.15	.95	1/2	1	
	100	2.70	2.30	1.80	1.55	.85	PUMP ONLY		
	150	2.70	2.30	1.80	1.55	.85	PUMP ONLY		
PKR-P-9	0	9.40	7.50	6.10	5.10	3.80	1/2	3	
	25	7.00	5.60	4.65	3.80	2.85	1/2	1	
	50	4.45	3.50	2.90	2.40	2.15	PUMP ONLY		
PKR-P-15	0	15.70	12.45	9.90	8.25	6.10	1/2	3	
	25	12.00	9.60	7.40	6.70	4.80	1/2	1	
	50	9.20	7.60	7.00	6.00	3.60	PUMP ONLY		
PKR-P-25	0	24.00	19.50	15.80	13.20	9.70	1-1/2	3	
	25	22.00	17.70	14.40	12.00	8.80	1-1/2	3	
	50	19.50	15.60	12.80	10.60	7.90	PUMP ONLY		
PKR-P-50	0	53.20	42.50	34.80	29.00	21.40	2	3	
	25	39.50	30.50	24.75	21.60	16.00	2	3	
	50	25.00	20.25	16.50	13.80	10.00	PUMP ONLY		

PLEASE NOTE A PRESSURE RELIEF VALVE MAY BE REQUIRED TO ACHIEVE CERTAIN PRESSURES ON SOME APPLICATIONS OR TO DIVERT FLOW OF EXCESSIVE PRESSURE BACK TO TANK OR SYSTEM WHEN NOT REQUIRED.

Stationary system with PSK 15gpm Pump



Model  
N100-2-15-TCS

